

Liefer – Portfolio Tellerkopfschraube Artikelbeschreibung – ØD x SD – M x L	Oberfläche	Artikelnummer
Gewinde M5		
TKS 28,0 x 2,0 / ST 5 x 14 - 5.6	Oberfläche VW t602, TL 245	210-05014-001
TKS SW 29,4-0,1 x 2,0 / ST 5 x 14 - 5.6	ZnNi VW 13750 r642	210-05014-002
Gewinde M6		
TKS SW 23,7 x 4,0 M6 x 12 - 8.8	Oberfläche blank	210-06012-001
TKS SW 23,7 x 4,0 M6 x 12 - 8.8	Ofi. GME 00252- A7	210-06012-004
TKS 19,7 x 2,0 M6 x 18 - A2/A4	Edelstahl A4 - gebeizt	210-06018-001
TKS 24 x 2,0 M6 x 12 - A4	Edelstahl A4	210-06012-005
TKS 24 x 2,0 M6 x 18 - A4	Edelstahl A4	210-06018-002
TKS 25 x 2,0 M6 x 8 - 5.6	blau verzinkt (6-8 µm)	210-06008-004
TKS 25 x 2,0 M6 x 8 - 8.8	blau verzinkt (6-8 µm)	210-06008-005
TKS 25 x 2,0 M6 x 10 - 8.8	blau verzinkt (6-8 µm)	210-06010-003
TKS 25 x 2,0 M6 x 13,5 - 8.8	blau verzinkt (6-8 µm)	210-06013-003
TKS 25 x 2,0 M6 x 14 - 8.8	blau verzinkt (6-8 µm)	210-06014-001
TKS 25 x 2,0 M6 x 15 - 5.6	blau verzinkt (6-8 µm)	210-06015-003
TKS 25 x 2,0 M6 x 17 - 8.8	blau verzinkt (6-8 µm)	210-06017-001
TKS 25 x 2,0 M6 x 33 - 8.8	blau verzinkt (6-8 µm)	210-06033-002
TKS 30 x 2,0 M6 x 15 - 8.8	blau verzinkt (6-8 µm)	210-06015-004
Gewinde M8		
TKS 28,0 - 0,5 x 2 M8 x 32- 8.8	Oberfläche VW t602, TL 245	210-08032-001
TKS 29 x 2,0 M8 x 10 - 8.8	blau verzinkt (6-8 µm)	210-08010-004
TKS 29 x 2,0 M8 x 15 - 8.8	blau verzinkt (6-8 µm)	210-08015-008
TKS 29 x 2,0 M8 x 15 - A2-A4	Edelstahl A2/A4 - gebeizt	210-08015-003
TKS 29 x 2,0 M8 x 20 - A4	Edelstahl A4	210-08020-006
TKS 29 x 2,0 M8 x 21 - 5.6	blau verzinkt (6-8 µm)	210-08021-002
TKS 29 x 2,0 M8 x 23 - A4	Edelstahl A4	210-08023-001
TKS 30 x 2,0 M8 x 20,5 8.8	Zinklad 250 chrom VI frei	210-08020-007
TKS 30 x 2,0 M8 x 8 - 5.6	blau verzinkt (6-8 µm)	210-08008-001
TKS 39 M8 x 23 - A4 - DIN 85	Edelstahl A4	210-08023-002
TKS 39 x 2 M8 x 15/16 - A2	Edelstahl A2	210-08015-007
TKS 40 x 2,0 M8 x 10 - 8.8	Zinklad 250 chrom VI frei	210-08010-003
TKS 40 x 2,0 M8 x 12,5 - 8.8	blau verzinkt (6-8 µm)	210-08012-004
TKS 40 x 2,0 M8 x 15 - 5.6	blau verzinkt (6-8 µm)	210-08015-002
TKS 40 x 2,0 M8 x 23 - 5.6	blau verzinkt (6-8 µm)	210-08023-004

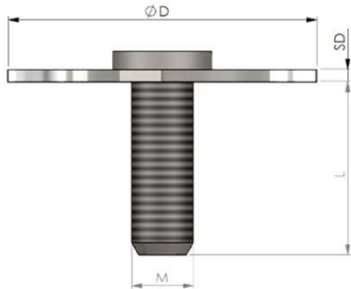

Liefer – Portfolio Tellerkopfschraube Artikelbeschreibung – ØD x SD – M x L		Oberfläche	Artikelnummer
Gewinde M8			
TKS 40 x 2,0 M8 x 23 - A4		Edelstahl A4	210-08023-005
TKS 40 x 2,0 M8 x 25 - 8.8		Zinklad 250 chrom VI frei	210-08025-004
TKS 40 x 2,0 M8 x 37- 8.8		blau verzinkt (6-8 µm)	210-08037-001
TKS 40 x 2,0 M8 x 48 -8.8		blau verzinkt (6-8 µm)	210-08048-001
TKS 50 x 2,0 M8 x 10 - A2		Edelstahl A2	210-08010-002
TKS RE 68,0 x 20,0 x 2,0 M8 x 15 - A2		Edelstahl A2	210-08015-006
TKS RE 68,0 x 38,0 x 2,0 M8 x 15 - A2		Edelstahl A2	210-08015-005
TKS SW 29,4 - 0,1 x 2 M8 x 16- 5.6		Oberfläche VW t602, TL 245	210-08016-005
TKS SW 29,4 - 0,1 x 2 M8 x 32- 8.8		ZnNi VW 13750 r642	210-08032-002
TKS SW 29,4 - 0,1 x 2 M8 x 32- 8.8		Oberfläche VW t602, TL 245	210-08032-003
TKS SW 30 - M8 x 12 - 8.8		blau verzinkt (6-8 µm)	210-08012-001
TKS SW 30 - M8 x 12 - 8.8		Oberfläche blank	210-08012-002
Gewinde M10			
TKS 40 x 2,0 M10 x 23 - 5.6		blau verzinkt (6-8 µm)	210-10023-001
TKS 40 x 2,0 M10 x 23 - A4		Edelstahl A4	210-10023-002
TKS 40 x 2,0 M10 x 30/26 - 5.6		mit Schlitz in Stirnfläche	210-10030-001
TKS 49 x 2,0 M10 x 10 - 5.6		blau verzinkt (6-8 µm)	210-10010-002
TKS 49 x 2,0 M10 x 15- 5.6		blau verzinkt (6-8 µm)	210-10015-001
TKS 49 x 2,0 M10 x 20 - 8.8		blau verzinkt (6-8 µm)	210-10020-011
TKS 49 x 2,0 M10 x 25/26 - 8.8		blau verzinkt (6-8 µm)	210-10025-006
TKS 49 x 2,0 M10 x 28 - A2		Edelstahl A2	210-10028-003
TKS 49 x 2,0 M10 x 28 - A4		Edelstahl A4	210-10028-007
TKS 49 x 2,0 M10 x 30 - 5.6		blau verzinkt (6-8 µm)	210-10030-002
TKS 50 x 2,0 M10 x 15 - 5.6		Fe/Zn Dickschichtpass.(8-10µm)Cr-VI-frei	210-10015-003
TKS 50 x 2,0 M10 x 28 - 8.8		Zinklad 250 chrom VI frei	210-10028-008
TKS 50 x 2,0 M10 x 34 - 8.8		Zinklad 250 chrom VI frei	210-10034-002
TKS 52 x 3,0 M10 x 20 - 8.8 / Kopf-ø20x4		Oberfläche blank	210-10020-005
TKS 70 x 3,0 M10 x 25 - 5.6		blau verzinkt (6-8 µm)	210-10025-004
TKS 70 x 3,0 M10 x 25 - 5.6		DIN 50979 Fe/ Zn Ni 8/ Cn/ T2	210-10025-007
TKS 70 x 3,0 M10 x 30 - 5.6		blau verzinkt (6-8 µm)	210-10030-004
TKS 70 x 3,0 M10 x 9 - 5.6		blau verzinkt (6-8 µm)	210-10009-001
TKS 70 x 3,0 M10 x 9 - 5.6		DIN 50979 Fe/ Zn Ni 8/ Cn/ T2	210-10009-002

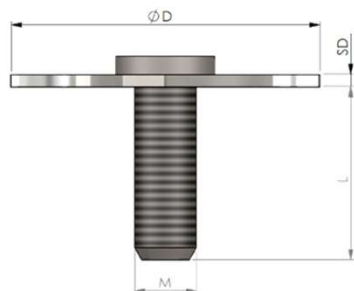

Liefer – Portfolio Tellerkopfschraube Artikelbeschreibung – ØD x SD – M x L	Oberfläche	Artikelnummer
Gewinde M12		
TKS 70 x 3,0 M12 x 37 - 5.6	Oberfläche blank	210-12037-001
TKS 73 x 3,0 M12 x 25 - 5.6	blau verzinkt (6-8 µm)	210-12025-001
TKS 73 x 3,0 M12 x 37 - 5.6	blau verzinkt (6-8 µm)	210-12037-007
TKS 73 x 3,0 M12 x 37 - 5.6	Fe/Zn Dickschichtpass.(8-10µm)Cr-VI-frei	210-12037-009
TKS 73 x 3,0 M12 x 37 - A4	Edelstahl A4	210-12037-010
TKS 73 x 3,0 M12 x 62 - 8.8	blau verzinkt (6-8 µm)	210-12062-001
TKS 73 x 3,0 M12 x 82 - 8.8	blau verzinkt (6-8 µm)	210-12082-001
TKS 75 x 3,0 M12 x 25 - 8.8	Oberfläche blank	210-12025-002
TKS 75 x 3,0 M12 x 25 - 8.8	Oberfläche blank	210-12025-002
TKS 75 x 3,0 M12 x 27 - 8.8	blau verzinkt (min. 8µm)	210-12027-006
TKS 75 x 3,0 M12 x 37 - 8.8	Zinklad 250 chrom VI frei	210-12037-005
TKS 75 x 3,0 M12 x 47 - 8.8	Oberfläche blank	210-12047-002
TKS 85,0 x 4,0 M12 x 26 - 8.8	blau verzinkt (6-8 µm)	210-12026-002
TKS 85,0 x 4,0 M12 x 26 - 8.8	blau verzinkt (6-8 µm)	210-12026-002
Gewinde M16		
TKS 95,0 x 4,0 M16 x 41 - 5.6	Fe/Zn Dickschichtpass (8-10µm)Cr-VI-frei	210-16041-006
TKS 95,0 x 4,0 M16 x 41/43 - 8.8	blau verzinkt (6-8 µm)	210-16043-001
TKS 98,0 x 4,0 M16 x 46 - A4	Edelstahl A4	210-16046-005
TKS 99,8 x 4,0 M16 x 21 - 8.8	blau verzinkt (6-8 µm)	210-16021-001
TKS 99,8 x 4,0 M16 x 30/31-A4	Edelstahl A4	210-16031-003
TKS 99,8 x 4,0 M16 x 31/30 - 8.8	blau verzinkt (6-8 µm)	210-16031-001
TKS 99,8 x 4,0 M16 x 43 - 8.8	Zinklad 250,chrom Vi frei	210-16043-003
TKS 99,8 x 4,0 M16 x 46 - 8.8	blau verzinkt (6-8 µm)	210-16046-004
TKS 115,0 x 4,0 M16 x 41 - 5.6	Fe/Zn Dickschichtpass.(8-10µm)Cr-VI-frei	210-16041-005
TKS 130,0 x 4,0 M16 x 25 - 8.8	blau verzinkt (6-8 µm)	210-16025-001
TKS 130,0 x 4,0 M16 x 51 - 8.8	blau verzinkt (6-8 µm)	210-16051-001
TKS 145 x 5,0 M16 x 45 - 5.6	Fe/Zn Dickschichtpass (8-10µm)Cr-VI-frei	210-16045-005
TKS 148 x 5,0 M16 x 45 - 8.8	blau verzinkt (6-8 µm)	210-16045-006
TKS 148,0 x 5 M20 x 45,0 - 8.8	blau verzinkt (6-8 µm)	210-20045-002
TKS 148,0 x 5 M20 x 45,0 - A4	Edelstahl A4	210-20045-001
TKS DT 163,5 x 8 M20 x 22,0 - 8.8	Oberfläche blank	210-20022-001